

## Picage met rubberen afdichting

### OMSCHRIJVING

Picage roestvrij staal 1.4301,

met rubberen afdichting.

Ø d3 100 tot 500.

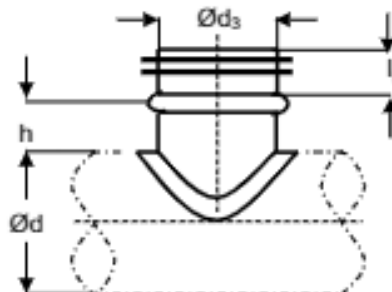

Ød <sub>3</sub> DN	Ød DN	h (mm)	Weight (kg)	Ød <sub>3</sub> DN	Ød DN	h (mm)	Weight (kg)
100	100	60	0.4	125	630	60	0.5
100	125	60	0.4	125	710	60	0.5
100	140	60	0.4	140	140	60	0.6
100	150	60	0.4	140	150	60	0.6
100	160	60	0.4	140	160	60	0.6
100	180	60	0.4	140	180	60	0.6
100	200	60	0.4	140	200	60	0.6
100	224	60	0.4	140	224	60	0.6
100	250	60	0.4	140	250	60	0.6
100	280	60	0.4	140	280	60	0.6
100	300	60	0.4	140	300	60	0.6
100	315	60	0.4	140	315	60	0.6
100	355	60	0.4	140	355	60	0.6
100	400	60	0.4	140	400	60	0.6
100	450	60	0.4	140	450	60	0.6
100	500	60	0.4	140	500	60	0.6
100	560	60	0.4	140	560	60	0.6
100	600	60	0.4	140	600	60	0.6
100	630	60	0.4	140	630	60	0.6
125	125	60	0.5	140	710	60	0.6
125	140	60	0.5	150	150	60	0.6
125	150	60	0.5	150	160	60	0.6
125	160	60	0.5	150	180	60	0.6
125	180	60	0.5	150	200	60	0.6
125	200	60	0.5	150	224	60	0.6
125	224	60	0.5	150	250	60	0.6
125	250	60	0.5	150	280	60	0.6
125	280	60	0.5	150	300	60	0.6
125	300	60	0.5	150	315	60	0.6
125	315	60	0.5	150	355	60	0.6
125	355	60	0.5	150	400	60	0.6
125	400	60	0.5	150	450	60	0.6
125	450	60	0.5	150	500	60	0.6
125	500	60	0.5	150	560	60	0.6
125	560	60	0.5	150	600	60	0.6
125	600	60	0.5	150	710	60	0.6



## Picage met rubberen afdichting

Ød <sub>3</sub> DN	Ød DN	h (mm)	Weight (kg)	Ød <sub>3</sub> DN	Ød DN	h (mm)	Weight (kg)
150	800	60	0.6	200	630	60	0.8
160	160	60	0.7	200	710	60	0.8
160	180	60	0.7	200	800	60	0.8
160	200	60	0.7	200	900	60	0.8
160	224	60	0.7	200	1000	60	0.8
160	250	60	0.7	200	1120	60	0.8
160	280	60	0.7	200	1250	60	0.8
160	300	60	0.7	224	224	60	1.1
160	315	60	0.7	224	250	60	1.1
160	355	60	0.7	224	280	60	1.1
160	400	60	0.7	224	300	60	1.1
160	450	60	0.7	224	315	60	1.1
160	500	60	0.7	224	355	60	1.1
160	560	60	0.7	224	400	60	1.1
160	600	60	0.7	224	450	60	1.1
160	630	60	0.7	224	500	60	1.1
160	710	60	0.7	224	560	60	1.1
160	800	60	0.7	224	600	60	1.1
180	180	60	0.7	224	630	60	1.1
180	200	60	0.7	224	710	60	1.1
180	224	60	0.7	224	800	60	1.1
180	250	60	0.7	224	900	60	1.1
180	280	60	0.7	224	1000	60	1.1
180	300	60	0.7	224	1120	60	1.1
180	315	60	0.7	224	1250	60	1.1
180	355	60	0.7	250	250	60	1.3
180	400	60	0.7	250	280	60	1.3
180	450	60	0.7	250	300	60	1.3
180	500	60	0.7	250	315	60	1.3
180	560	60	0.7	250	355	60	1.3
180	600	60	0.7	250	400	60	1.3
180	630	60	0.7	250	450	60	1.3
180	710	60	0.7	250	500	60	1.3
180	800	60	0.7	250	560	60	1.3
200	200	60	0.8	250	600	60	1.3
200	224	60	0.8	250	630	60	1.3
200	250	60	0.8	250	710	60	1.3
200	280	60	0.8	250	800	60	1.3
200	300	60	0.8	250	900	60	1.3
200	315	60	0.8	250	1000	60	1.3
200	355	60	0.8	250	1120	60	1.3
200	400	60	0.8	250	1250	60	1.3
200	450	60	0.8	280	280	60	1.3
200	500	60	0.8	280	300	60	1.3
200	560	60	0.8	280	315	60	1.3
200	600	60	0.8	280	355	60	1.3



## Picage met rubberen afdichting

Ød3 DN	Ød DN	h (mm)	Weight (kg)
560	900	90	4.5
560	1000	90	4.5
560	1120	90	4.5
560	1250	90	4.5
600	600	90	5.1
600	630	90	5.1
600	710	90	5.1
600	800	90	5.1
600	900	90	5.1
600	1000	90	5.1
600	1120	90	5.1
600	1250	90	5.1
630	630	90	5.7
630	710	90	5.7
630	800	90	5.7
630	900	90	5.7
630	1000	90	5.7
630	1120	90	5.7
630	1250	90	5.7
710	710	110	7.6
710	800	110	7.6
710	900	110	7.6
710	1000	110	7.6
710	1120	110	7.6
710	1250	110	7.6
800	800	110	10.5
800	900	110	10.5
800	1000	110	10.5
800	1120	110	10.5
800	1250	110	10.5
900	900	110	16.5
900	1000	110	16.5
900	1120	110	16.5
900	1250	110	16.5
1000	1000	110	26.5
1000	1120	110	26.5
1000	1250	110	26.5
1120	1120	110	30.0
1120	1250	110	30.0
1250	1250	110	33.1