

AANVRAAGFORMULIER TEXTIELKANALEN

FORMULAIRE GAINES TEXTILES

BEDRIJF/SOCIÉTÉ: _____ CONTACT: _____

E-MAIL: _____ TEL: _____

Gebruik/Usage: industrie magazijn/magasin clean room tertiair(e) - bureau - kantoor/office

Thermisch/Thermique: koud/froid warm/chaud koud+warm/froid+chaud transport ventilatie/ventilation

Technische gegevens /Données techniques:

- Debiet/Débit (m³/h) _____ m³/h
- Statische druk ter beschikking/pression statique disponible: _____ Pa
- Vochtigheid/humidité: _____ %
- Omgevingstemperatuur/température ambiante zomer/été _____ °C winter/hiver _____ °C
- Uitblaastemperatuur/température de refoulement zomer/été _____ °C winter/hiver _____ °C

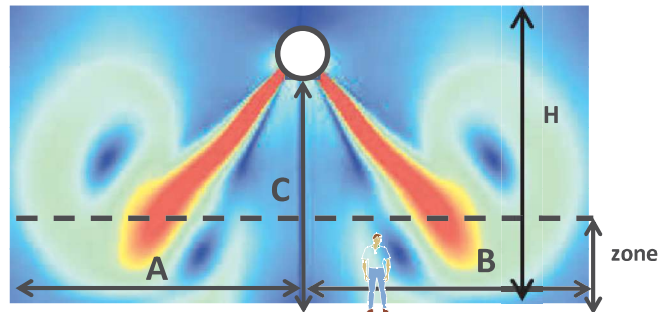
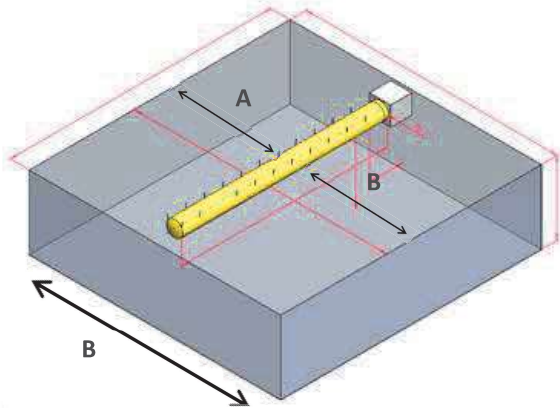

Duct Number	Location	Quantity	Airflow (m ³ /h)	Pressure (Pa)	Room Height (m) H	Length /B (m) L/B	Duct height (C) (m)	Air throws (In the air flow direction)	
								Left (A) (m)	Right (B) (m)
1									
2									
3									
4									
5									
6									
7									
8									
9									

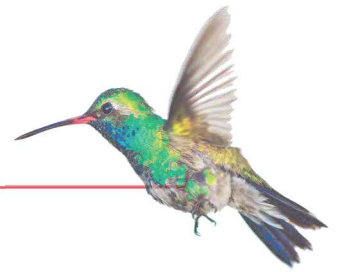

Vorm/Forme:

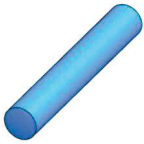

rond/ronde

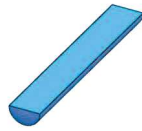

half rond/demi ronde (1/2)

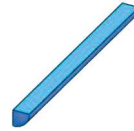

kwart rond/quart ronde (1/4)

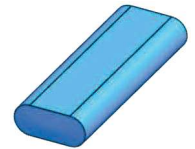

ovaal/ovale

andere vorm / forme différent

Kleur/Couleur - Materia(a):

- wit/blanc zwart/noir grijs/gris blauw/bleu rood/rouge geel/jaune groen/vert oranje/orange
 licht/clair donker/foncé



Polyester 80g



Polyester 160g

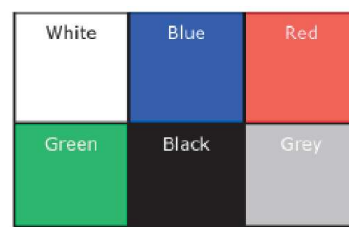

PVC



Texi Buz



Texi Jet



Texi Pulse



Texi Soft



Texi Duct



Texi Move

Ophanging/Suspension: (afhankelijk van de vorm/selon la forme)

monokabel galva / monocâble galva
-> rond(e)

monokabel inox / monocâble inox
-> rond(e)

bikabel galva / bicâble galva
-> rond(e) + ova(a)l(e)

bikabel inox / bicâble inox
-> rond(e) + ova(a)l(e)

rail aluminium

-> rond(e) + ova(a)l(e) + 1/2 + 1/4

profi(e)l PVC

-> rond(e) + ova(a)l(e) + 1/2 + 1/4

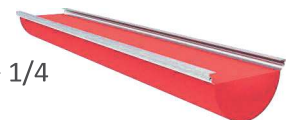

Bevestiging/Fixation:

- Bestaande kabel/câble existant bestaande rail/rails existant
 Rails en montage te voorzien/rails et raccords à fournir
 Inox accessoires te voorzien/accessoires inox à fournir
 Galva accessoires te voorzien/accessoires galva à fournir